

NOTE:
 CURRENT DESIGN ANTICIPATES APPROXIMATELY 22,509± SQ. FT. (0.52 ACRES) OF CLEARING AND GRADING FOR THE PROPOSED PROJECT. IF ADDITIONAL CLEARING IS REQUIRED BEYOND WHAT IS SHOWN ON THIS PLAN, THE CONTRACTOR SHALL NOTIFY THE ENGINEER AND/OR PROJECT MANAGER.

- GRADING NOTES:**
1. THE CONTRACTOR SHALL CLEAR AND GRUB THE SITE AND PLACE, COMPACT, AND MOISTURE CONDITION ALL FILL PER THE PROJECT GEOTECHNICAL ENGINEERS SPECIFICATIONS. FILL MATERIAL SHALL BE APPROVED BY THE GEOTECHNICAL ENGINEER PRIOR TO PLACEMENT.
 2. ELEVATIONS REFLECT FINISHED GRADES. CONTRACTOR SHALL BLEND EARTHWORK SMOOTHLY TO TRANSITION BACK TO EXISTING GRADE.
 3. PORTIONS OF THE SITE NOT SPECIFICALLY MENTIONED WITHIN THE GEOTECHNICAL REPORT SHALL BE CONSIDERED TO BE 10 PERCENT TO 15 PERCENT FINISH DRY MOISTURE CONTENT.
 4. FILL SHALL BE PLACED IN MAXIMUM 8" HIGH LOOSE LIFTS.
 5. UNDISTURBED AREAS WITHIN 30' INGRESS/EGRESS EASEMENT NOT NEEDED FOR UTILITY ROUTING TO BE LEFT UNDISTURBED.
 6. SOIL SHOULD BE REASONABLY EXPECTED TO BE WAITING OR MOISTURE CONDITIONING IS THE RESPONSIBILITY OF THE CONTRACTOR AND SHOULD BE INCLUDED IN THE CONTRACT PRICE.
 7. SEED ALL DISTURBED AREAS NOT TOPPED WITH GRAVEL PER SEEDING SCHEDULE ON METAL ON SHEET.
 8. MAXIMUM SLOPE = 2H:1V UNLESS OTHERWISE NOTED.
 9. MAXIMUM FILL SLOPE = 3H:1V UNLESS OTHERWISE NOTED.

LEGEND

EXISTING CONTOURS _____

PROPOSED CONTOURS _____

LOD/SILT FENCE _____ LOD _____

TPF _____ TPF _____

EXISTING SPOT ELEVATION x XXX

PROPOSED SPOT ELEVATION • XXX

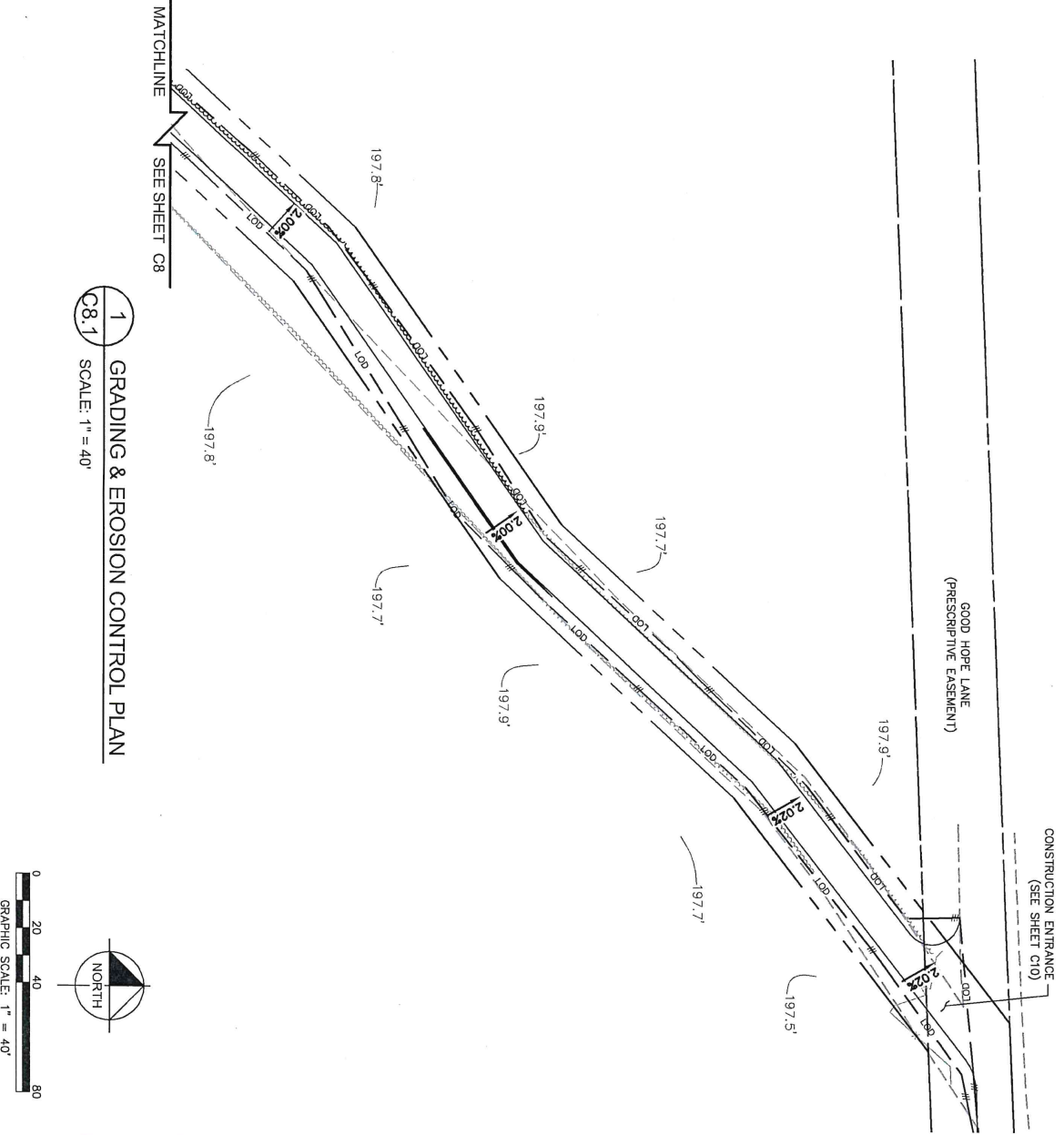

1 GRADING & EROSION CONTROL PLAN
 C8.1 SCALE: 1" = 40'

This document, together with the contracts and design presented herein, are an instrument of service, a standard only for the specific project and shall not be used for any other project. Issues of and proposed reliance on this document, without written authorization and approval by Verzion and Amecdelva, Inc. shall be without liability to Verzion and Amecdelva, Inc.

verizon
 1000 OLD ALABAMA ROAD, SUITE 600
 ALABAMA CITY, AL 35009

PROJECT INFORMATION:
 SITE NAME: OLD STATE ROAD
 SITE No.: 502591
 FLUZE PROJECT#: 15525785
 GOOD HOPE CIRCLE
 NATATOR, GA 31641
 LOMWES COUNTY

PLANS PREPARED BY:

Kimley-Horn
 11720 AMBER PARK DRIVE, SUITE 600
 ALPHARETTA, GA 30009
 WWW.KIMLEY-HORN.COM

REV: DATE: ISSUED FOR: BY:

7			
6			
5			
4			
3			
2			
1	05/16/20	CONSTRUCTION	WCE
A	05/12/20	PRELIMINARY	WCE

LICENSER:

GEORGIA REGISTERED PROFESSIONAL ENGINEER
 No. PE008811
WILLIAM C. EDMONSON
 ENGINEER

KHA PROJECT NUMBER: 013509094
 DRAWN BY: WCE
 CHECKED BY: WCE

SHEET TITLE: GRADING AND EROSION CONTROL PLAN
 SHEET NUMBER: C8.1

Copyright © Verzion and Amecdelva, Inc., 2020