

- REAR:25'
- THERE ARE NO WETLANDS PRESENT ON THIS PARCEL (0117A 009) PER NWI
- ACCORDING TO FLOOD INSURANCE RATE MAP FOR LOWWATER COUNTY, GA. MAP #131950300E EFFECTIVE DATE SEPTEMBER 26, 2008. THIS PROPERTY IS IN FLOOD ZONE "X", AN AREA DETERMINED TO BE OUTSIDE THE 0.2% ANNUAL CHANCE FLOODPLAIN.
- PARKING DATA:
 REQUIRED = 48
 PROVIDED = 54

NORFOLK SOUTHERN CORP. RAILROAD (100' R/W)

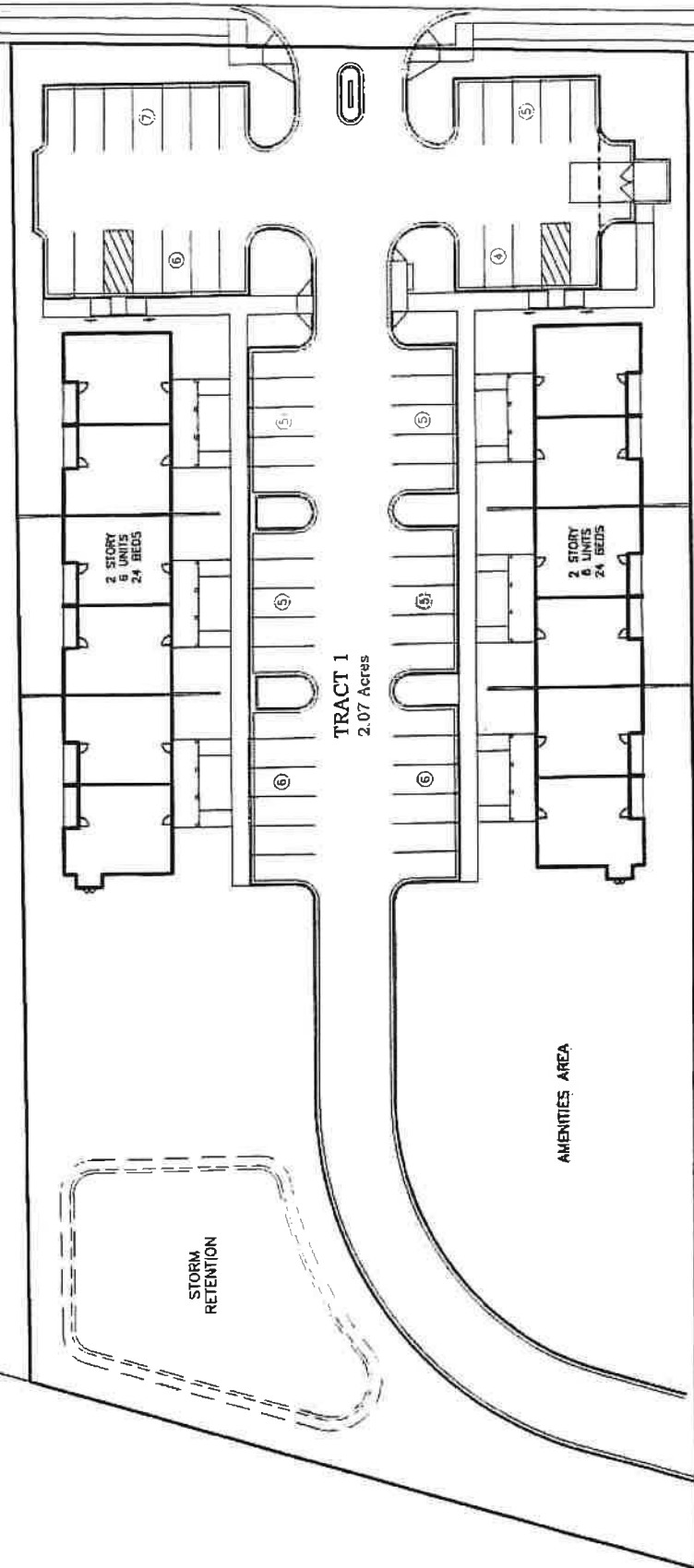

WEST GORDON STREET (45' R/W)

RDON STREET (45' R/W)

DIANA DR